

Permanent Split Capacitor Double Shaft Fan and Blower 5.6" Diameter, Two & Three Speed

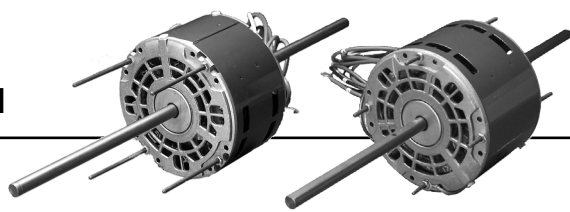

APPLICATIONS:

To meet manufacturer's requirements for blowers utilizing a double-shaft motor.

FEATURES:

- Open Dripproof, Air Over Except Where Noted
- Automatic Reset Thermal Overload Protector
- CCW Rotation Lead End
- Bearings Have All Angle Thrust System
- Continuous Duty, Air Over
- Green Ground Lead
- Connection & Capacitor Information Furnished on Nameplate
- Suitable for Use With 370V Capacitors
- Hub Rings Are 2-1/4" Diameter, Furnished Detached, With Extra Metal Rings For Adapting To 2-1/2" Diameter
- Mounting Holes In Shell For Mounting Capacitor
- When Supplied, Capacitor & Mounting Hardware Are Supplied Detached
- 20" Leads
- Class B Insulation
- Multiplier Symbol: DS-3HAC

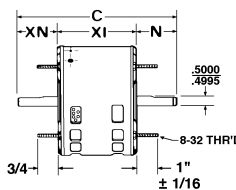

Figure A

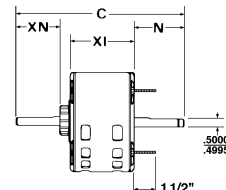

Figure B

Stud Mount, Without Capacitor & Mounting Kit, ECONOMIZER® High Efficiency (Figure A)

HP	RPM/ Spds.	Voltage	Catalog Number	List	Bearings	Cap. MFD	Amps	Shaft N	Shaft XN	Shell XI	Total C	Ship Wt. (lbs)	Notes	OEM
1/4	1625/3	230	8725	\$262	SAB	6.0	1.6	7.0	7.0	4.1	18.1	12		
1/8	1075/3	115	1186	\$259	SAB	5.0	2.1	6.0	6.0	3.9	15.8	12	H45	
	1075/3	208-230	1187	\$263	SAB	5.0	0.9	6.0	6.0	3.9	15.8	12	H45	
1/3	1625/3	230	8726	\$271	SAB	7.5	1.9	7.0	7.0	4.3	18.3	13		

Resilient Mounting With Capacitor and Mounting Kit, Two Speed (Figure B)

HP	RPM/ Spds.	Voltage	Catalog Number	List	Bearings	Cap. MFD	Amps	Shaft N	Shaft XN	Shell XI	Total C	Ship Wt. (lbs)	Notes	OEM
1/4	1075/2	115	1244	\$200	SAB	5.0	4.4	7.0	7.0	4.4	19.4	16	RB	
	1625/2	115	1242	\$212	SAB	3.0	3.6	7.0	7.0	3.9	18.9	13	RB	
	1625/2	230	1243	\$218	SAB	3.0	1.8	7.0	7.0	3.9	18.9	12	RB	
1/2	1075/2	230	1248	\$149	SAB	5.0	3.3	7.0	7.0	4.9	19.9	19	RB	

Hub or Stud Mount (Except Where Noted), With Capacitor and Mounting Kit, Three Speed (Figure B)

HP	RPM/ Spds.	Voltage	Catalog Number	List	Bearings	Cap. MFD	Amps	Shaft N	Shaft XN	Shell XI	Total C	Ship Wt. (lbs)	Notes	OEM
1/6	1075/3	115	1240	\$187	SAB	5.0	2.9	7.0	7.0	3.7	18.7	12	RB	
1/5	1075/3	230	1152	\$148	SAB	5.0	1.4	5.1	5.1	3.8	13.4	13		GB
1/3	1625/3	230	1887	\$271	SAB	5.0	2.2	8.0	8.0	4.3	20.8	13		
	1075/3	230	1213	\$201	SAB	5.0	2.5	8.0	8.0	4.3	20.1	18		
	1100/3	230	5108	\$206	SAB	5.0	2.3	4.3	4.3	4.3	14.2	16		WP
	1075/3	230	1247	\$224	SAB	5.0	2.5	7.0	7.0	4.7	19.7	18	RB	
1/2	1075/3	230	1824	\$235	SAB	5.0	4.5	8.0	8.0	5.4	22.0	19		

Hub or Stud Mount, Without Capacitor and Mounting Kit *, Three Speed (Figure B)

HP	RPM/ Spds.	Voltage	Catalog Number	List	Bearings	Cap. MFD	Amps	Shaft N	Shaft XN	Shell XI	Total C	Ship Wt. (lbs)	Notes	OEM
1/8	1075/3	115	8523	\$199	SAB	5.0	2.1	7.0	7.0	3.7	20.1	11		
1/6	1075/3	115	12160	\$124	SAB	5.0	3.0	8.0	8.0	3.6	20.1	11		
1/4	1075/3	230	3134	\$189	SAB	5.0	2.0	8.0	8.0	4.6	20.1	13		
1/3	1075/3	230	3135	\$145	SAB	5.0	2.5	8.0	8.0	4.6	21.1	14		
1/2	1075/3	230	3136	\$158	SAB	5.0	4.5	8.0	8.0	5.4	22.0	20		

GB = Gibson® WP = Whirlpool® *To Make Resilient Mount, Order Kit Numbers 27 and 4. See Pages 188-189.

Note H45 Totally Enclosed Air Over

Note RB Resilient Mounting

† All marks shown within this document are properties of their respective owners.

