



GE APPLIANCES
a Haier company

Part Install Instructions

Lid Lock Replacement Kit

WH08X31577



IMPORTANT SAFETY NOTICE

The information in this part instruction is intended for use by individuals possessing adequate backgrounds of electrical, electronic and mechanical experience. Any attempt to repair a major appliance may result in personal injury and property damage. The manufacturer or seller cannot be responsible for the interpretation of this information, nor can it assume any liability in connection with its use.



WARNING

To avoid personal injury, disconnect power before servicing this appliance. If electrical power is required for diagnosis or test purposes, disconnect the power immediately after performing the necessary checks. **RECONNECT ALL GROUNDING DEVICES** If grounding wires, screws, straps, clips, nuts, or washers used to complete a path to ground are removed for service, they must be returned to their original position and properly fastened.

Parts Included:

- Lid Lock and Harness Assembly
- Metal Lid Bezel (White)
- Metal Lid Striker (White)
- Glass Lid Bezel (Gray)
- Glass Lid Striker (Gray)
- Install Instructions

Overview – The New Lid Lock assembly kit consists of 2 bezels (1 gray & 1 white) and 2 lid lock strikers (1 gray & 1 white). For washers with metal lids, use the white striker and white bezel. For washers with glass lids, use the gray striker and gray bezel. The lid switch/lock & harness assembly is compatible with both metal and glass lid washers. Follow these kit installation instructions beginning on page 2.

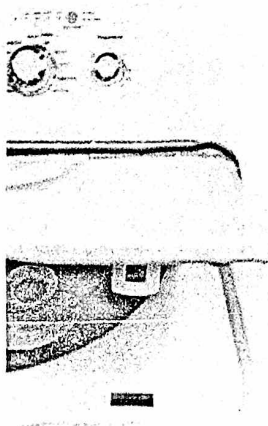

Metal Lid Washer

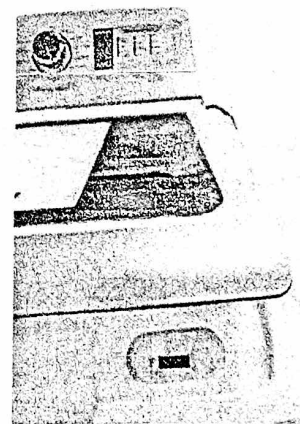
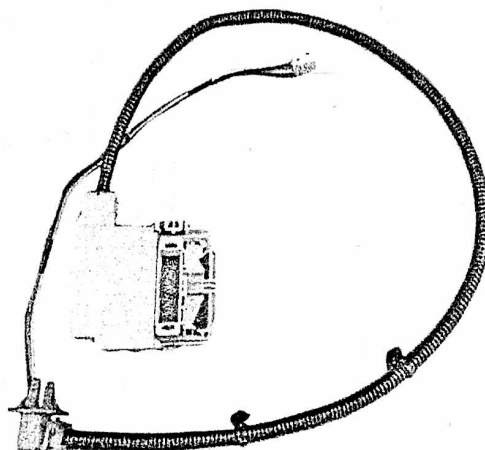

Glass Lid Washer

Step 1- Ensure lid is unlocked and remove electrical power from outlet for the washer being serviced.

Step 2- Remove the bezel by reaching under the top cover to release the bezel tabs. Push out and up on the tabs. See figure 1.

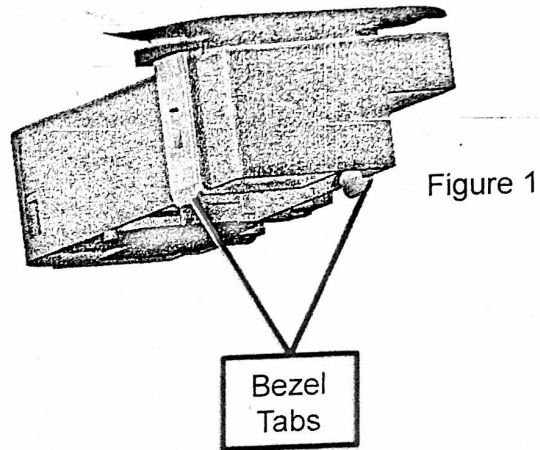

Step 3- Using a small screwdriver, push down gently on the locking tab that prevents the lock assembly from moving. See figure 2.

Step 4- Slide the lock assembly to the left first to disengage the right lock body tab. Then slide to the right, allowing the lock assembly to disengage from the top cover.

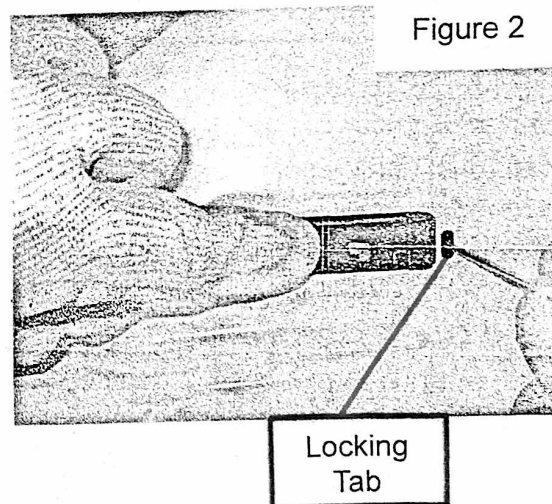

Step 5- Slide the lock assembly from under the top cover and disconnect the harness connector from the lock assembly. See figure 3.

NOTE: If the washer has a bulk tank, the steps on the last page need to be done first before raising the top cover. Otherwise, continue with Step 6.

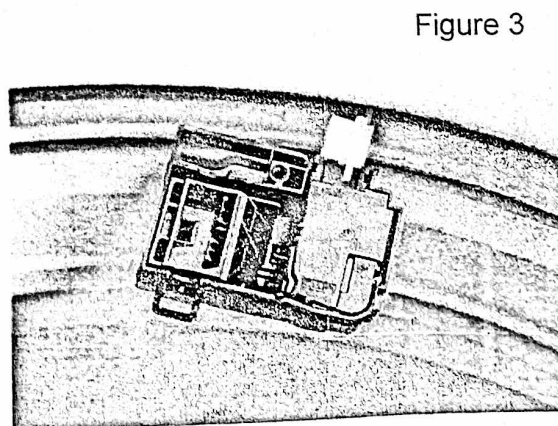

Step 6- Tape the lid to the top cover to ensure it will not fly open.

Step 7- Remove two 1/4 inch Hex Head Screws securing the backsplash to the top cover. See figure 4.

Step 8- Push and rotate the backsplash toward the rear of the washer to disengage the pressure tube from the main board.

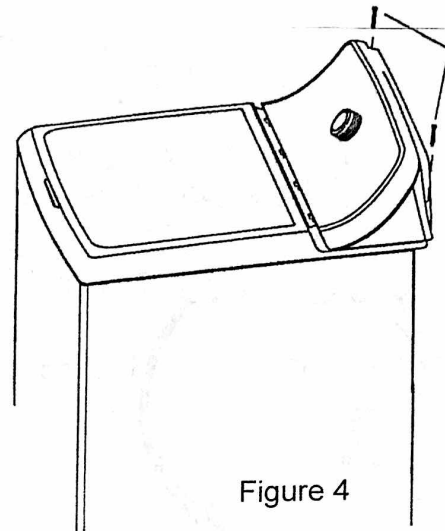

Figure 4

Step 9- Once the pressure tube is disengaged from the main board, rotate the backsplash toward the front of the washer. Depending on the model being serviced, remove the two hex head screws securing the backsplash to the top cover and then slide the rear panel to the right, or four hex head screws securing the rear panel to the backsplash. See figure 5. Disconnect the lid switch/lock harness from the main board and push through the top cover.

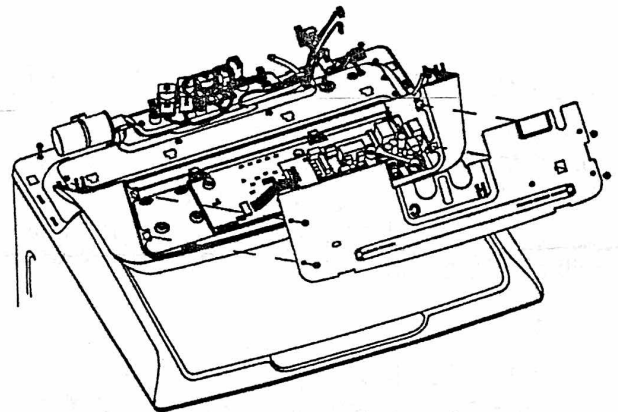

Figure 5

Step 10- Remove two 1/4 inch Hex Head screws at the rear of the top cover (one on each side) securing the top cover to cabinet. Unclip the two front clips and raise the top cover up to access the lid switch/lock harness. See figure 6.

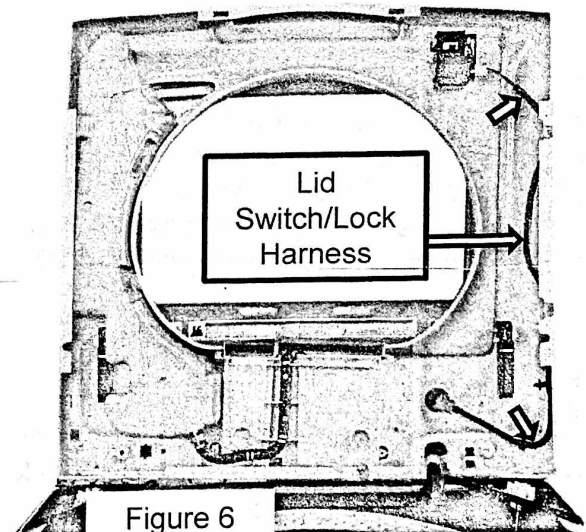

Figure 6

Step 11- Remove the original lid switch/lock harness from the top cover harness clips.

Step 12- Reinstall the new lid switch/lock harness assembly onto the top cover.

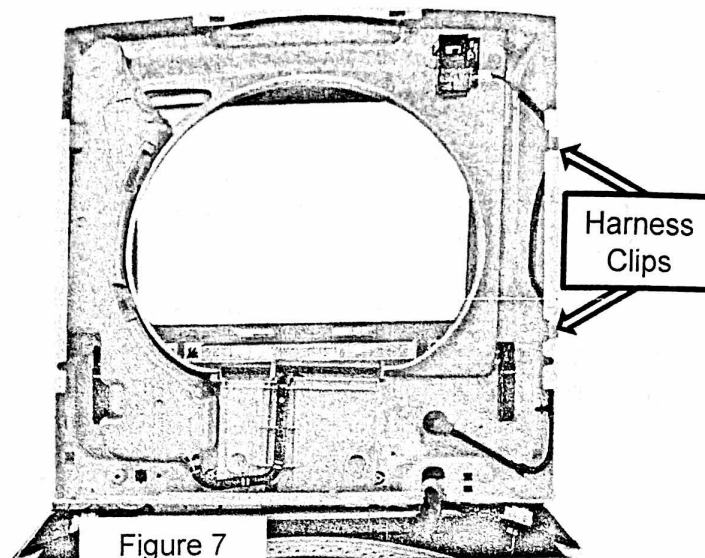
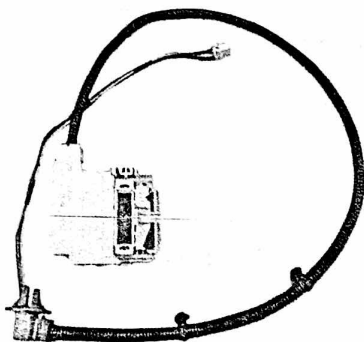

Figure 7

Step 13- When reinstalling the lid switch/lock assembly to the top cover, bring the left side tab of the lid switch/lock assembly up through the top cover opening first. Then slide it to the right. This will clip in place.

Step 14- Reattach the top cover to the cabinet. Then push the bezel through the top cover. Push down on both sides of the bezel until it clicks. This secures the bezel and lid switch/lock assembly in position.

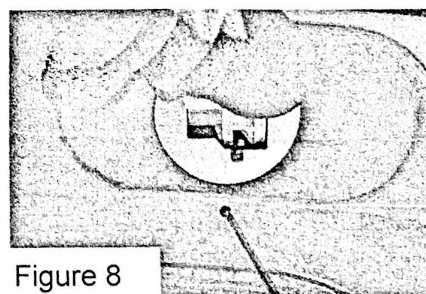

Figure 8

Step 15- Open the lid and remove the original lid lock striker. For metal lid remove two Phillips head screws. Glass lid, using a small screwdriver or paper clip, push in on the locking tab and twist the lid lock striker to remove. See figure 8 and 9.

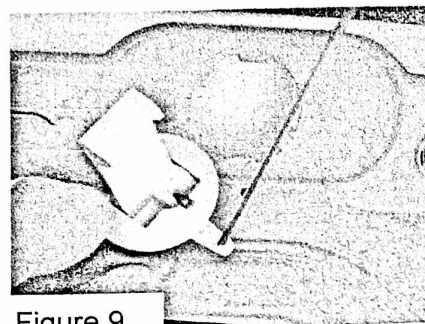

Figure 9

Step 16- To install the new lid lock striker, angle the lid lock striker to the left. Slide the locking tab in first, then seat the striker in the lid and turn to the right. This will lock the lid lock striker in place.

Step 17- Reconnect harness and pressure hose to the main board, reinstall backsplash assembly to the top cover.

Step 18- Resupply power to the washer and test for proper operation.

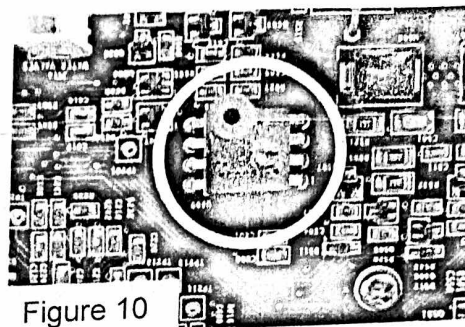

Figure 10

IMPORTANT: Before securing the backsplash to the top cover, Ensure the pressure hose did not slip off the port on the main board. See figure 10.

NOTE:

If the lid lock is in the "locked" position as seen in Figure 11, the lid will not close all the way. (DO NOT FORCE CLOSED) This is solved by using a pocket screwdriver to manually unlock the lid lock.

Using a pocket screwdriver, slide the locking bar in toward the backsplash as seen in figure 12. Once the lid lock mechanism is manually pushed to the end as shown in figure 12, it will slide back automatically to its original unlocked position as shown in figure 13. This will allow the lid to be fully closed and for the washer to function.

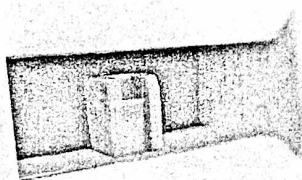

Figure 11

Locked Position

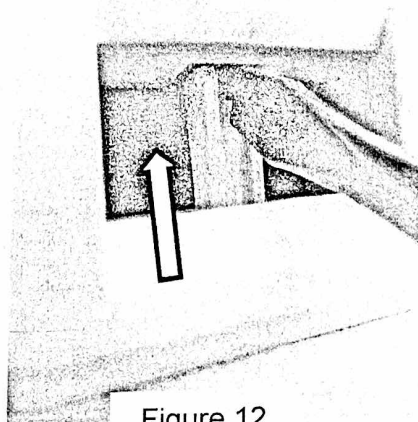

Figure 12

Slide Lock Bar All The Way In toward Backsplash With Screwdriver

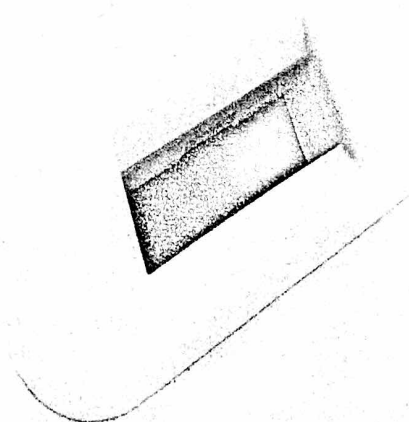

Figure 13

Lock Bar Will Slide Back To Unlocked Position

Steps to take if washer has a bulk tank.

Step 1- Before raising the top cover, if there is detergent in the bulk tank, reach under the dispenser box and feel for the rubber tube. Pull the tube downwards to disengage it from the dispenser box. See figure 4.

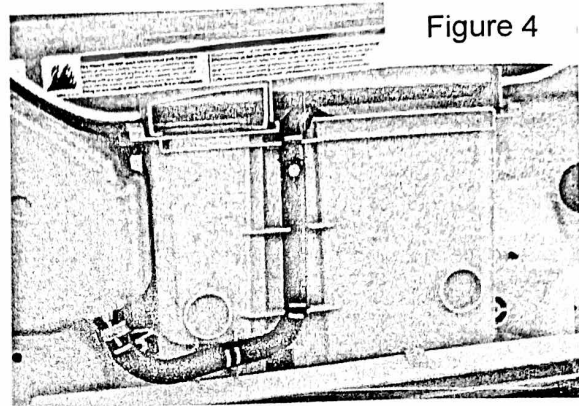

Figure 4

Step 2- Using a pair of pinch pliers, clamp the tube so the detergent does not flow from the bulk tank into the dispenser box. The tube is flexible and does not take much pressure to clamp it closed. Drain hose and or Air-conditioning pinch off pliers both work well. See figure 5.

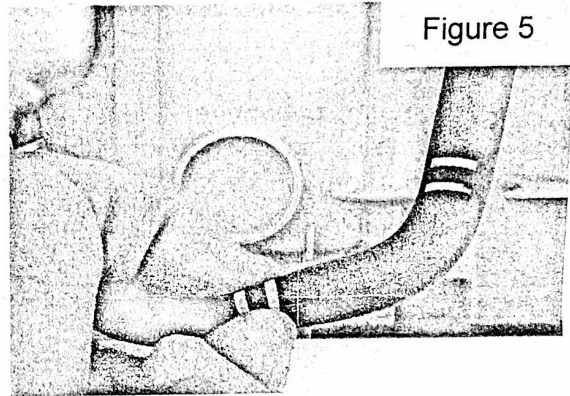

Figure 5

Step 3- Remove the bleach/ bulk tank funnel by reaching between the top cover and tub cover and push up on the bottom of the funnel.

To prevent detergent from spilling out of the tank fill opening while servicing or removing the washer from a drain pan, because the tank does not seal closed, a sponge or magic eraser can be inserted into the tank opening to prevent detergent for spilling out. See figure 6.

Then raise the top cover to access the lid lock harness.

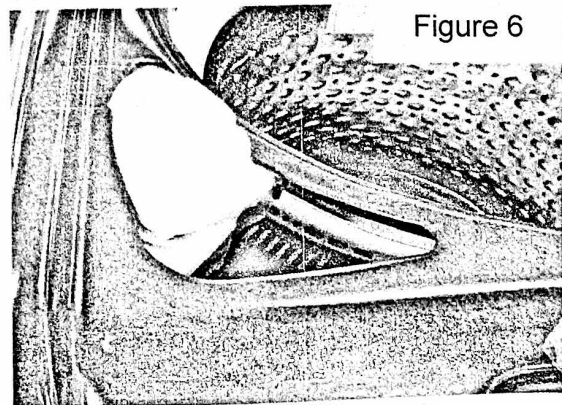

Figure 6